

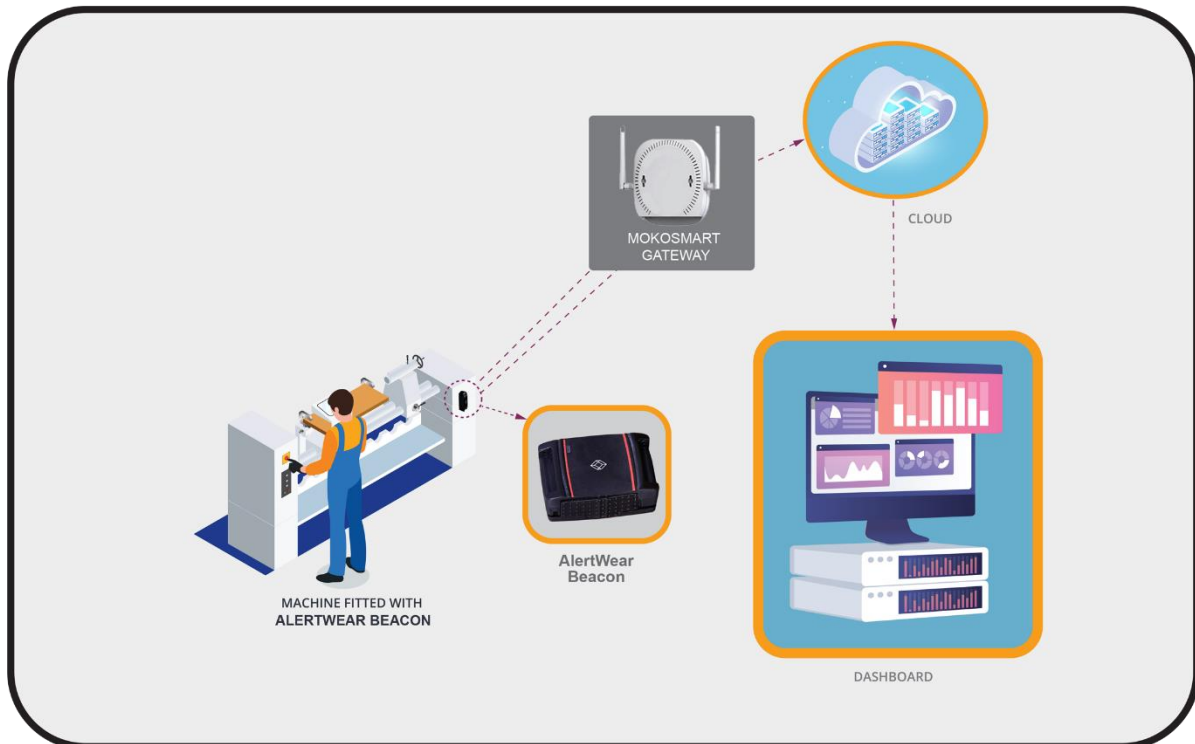

AlerWear T20 Step by Step User Guide V1.0

Black Box Corporation



Contents

1	Company Login	3
2	After Login.....	3
2.1	Device Detail.....	3
2.2	Import Device Configuration - Using CSV	4
2.3	Device Configuration List.....	4
2.4	Firmware updates Log.....	5
3	Mobile App.....	6

1 Company Login

User will receive the Login Credentials' for Company via email.

URL: http://doguz.io/t20_final/login

User ID – Company User ID received via email.

Password – Corresponding Password received via email.

Note: User can change the default password if required.

2 After Login

After successful login company users can do below things.

2.1 Device Detail

Company users can view all the devices that have been assigned to them.

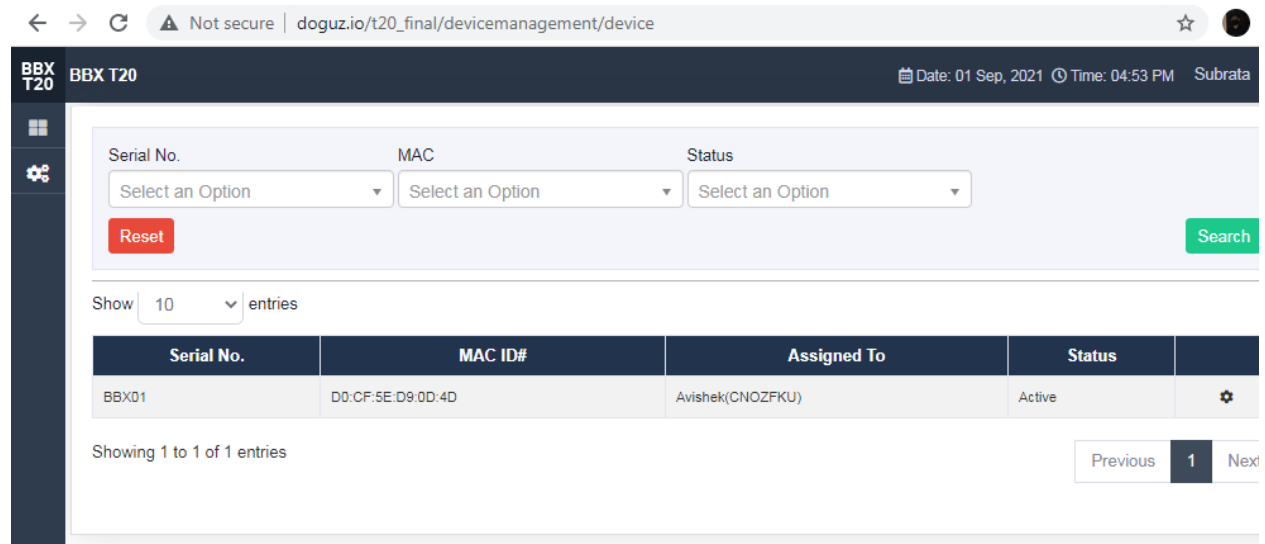

The screenshot shows a web browser window with the URL doguz.io/t20_final/devicemanagement/device. The page header includes the BBX T20 logo, the date 01 Sep, 2021, the time 04:53 PM, and the user name Subrata. The main content area features a search filter with three dropdown menus for Serial No., MAC, and Status, each with a 'Select an Option' placeholder. A red 'Reset' button is on the left and a green 'Search' button is on the right. Below the filter is a 'Show 10 entries' dropdown. The table below has columns for Serial No., MAC ID#, Assigned To, and Status. One entry is visible: Serial No. BBX01, MAC ID# D0:CF:5E:D9:0D:4D, Assigned To Avishek(CNOZFKU), and Status Active. A gear icon is in the rightmost column. At the bottom, it says 'Showing 1 to 1 of 1 entries' and has 'Previous', '1', and 'Next' navigation buttons.

Serial No.	MAC ID#	Assigned To	Status	
BBX01	D0:CF:5E:D9:0D:4D	Avishek(CNOZFKU)	Active	⚙️

2.4 Firmware updates Log

Once firmware is being updated using the mobile app. System also maintain log of device configuration.

The screenshot displays the 'Edit Floor' configuration page in the BBX T20 IoT-enabled Asset Tracking Solution. The interface includes a sidebar with navigation options: Dashboard, Settings, History Log, and Reports. The main content area shows the following configuration details:

- MAC***: 84:71:27:21:84:71
- Firmware Version***: 5.0
- Firmware Update Time***: 2021-05-11 22:34:08
- Sync. By***: admin
- Created At***: 2021-05-11 22:34:08.741567

Below the configuration fields is a 'Log Data' table with the following structure:

Title	Value	Is Updated?
Start Working Time	9	No
End Working Time	23	No
Device Name	BLACK BOX 71	Yes
UUID	e5c56db5-dffb-48d2-b060-d0f5a71096e0	No
TX.power (dBm)	-1	No
Transmission Interval (ms)	200	No
Major	88	No
Minor	252	No
Temp Memory Record interval (minutes)		No

3 Mobile App

The Android Mobile Application is available in play store. User can also download and install the app using below link.

https://play.google.com/store/apps/details?id=com.bbx.t20configdata&hl=en_IN&gl=US

1. After opening the application, user has to Login using User ID & Password.

Checking Internet connection and proper credential, the application performs Sign In operation.

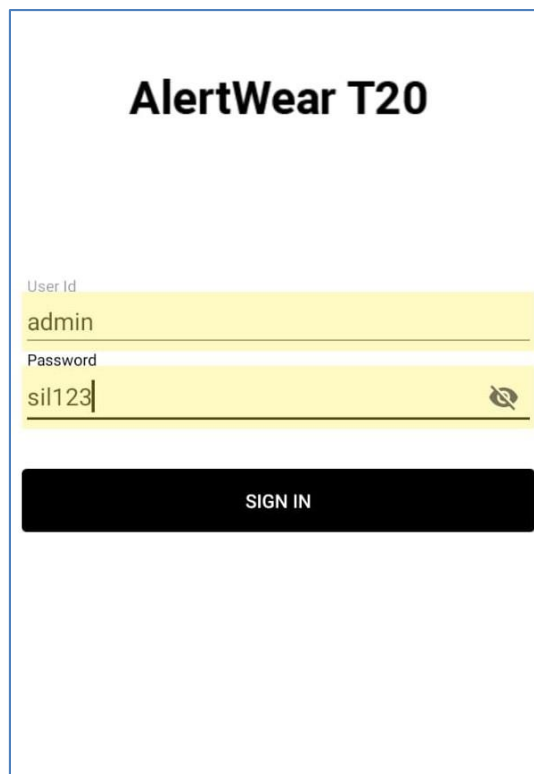

AlertWear T20

User Id
admin

Password
sil123

SIGN IN

2. After successful Log In, User will redirect to Scan Page. Here MAC Id of nearby Device will be scanned and store until the app is closed.

Click on “**Sync Data**” button to download the Alertwear configuration detail from web portal based on Scanned MAC Id to the mobile app locally.

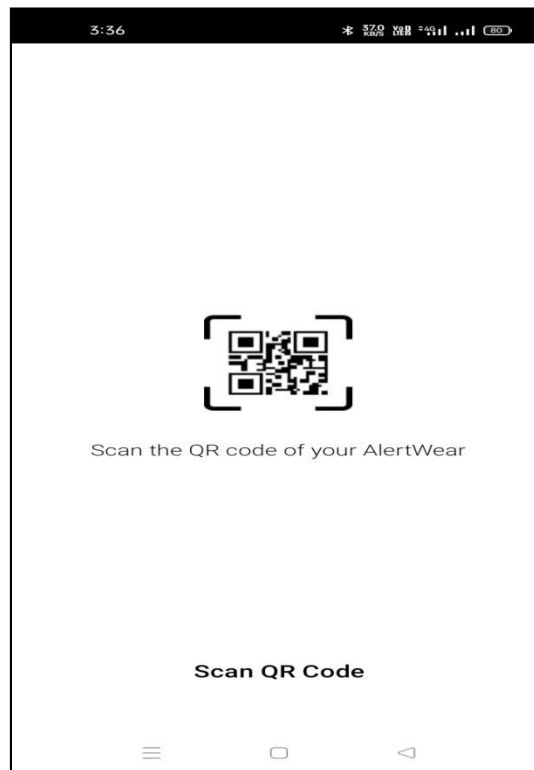

3. Clicking on “**GO**” button, User will redirect to Update page. Click on “**Update Alertwear**” button. It may be show a message “**Please wait**” if the internal process for updating data is still remaining.

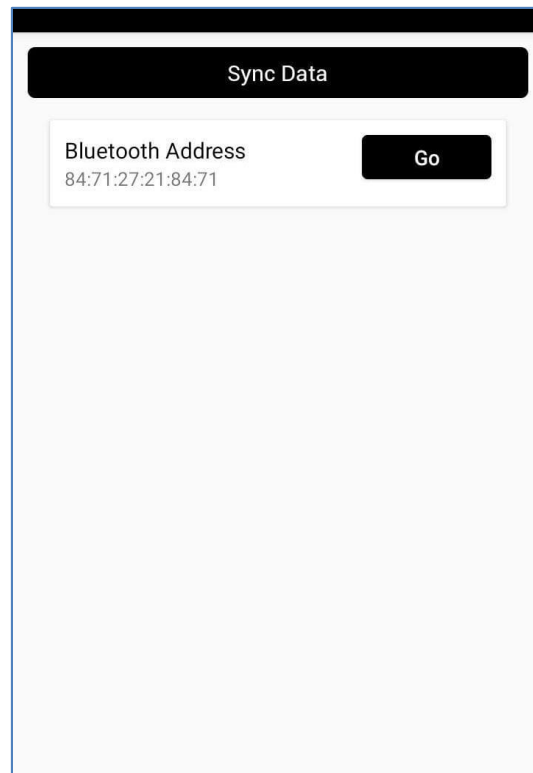

4. Clicking this button all updatable data will be written to nearby selected Beacon device and after successful completion of that, a Dialog will appear to confirm to change Device Name. If user wants, there is also a place to put Device Name (16 character. max). After changing the Device Name all the updated data will be synced to web portal and the entire process will be completed.

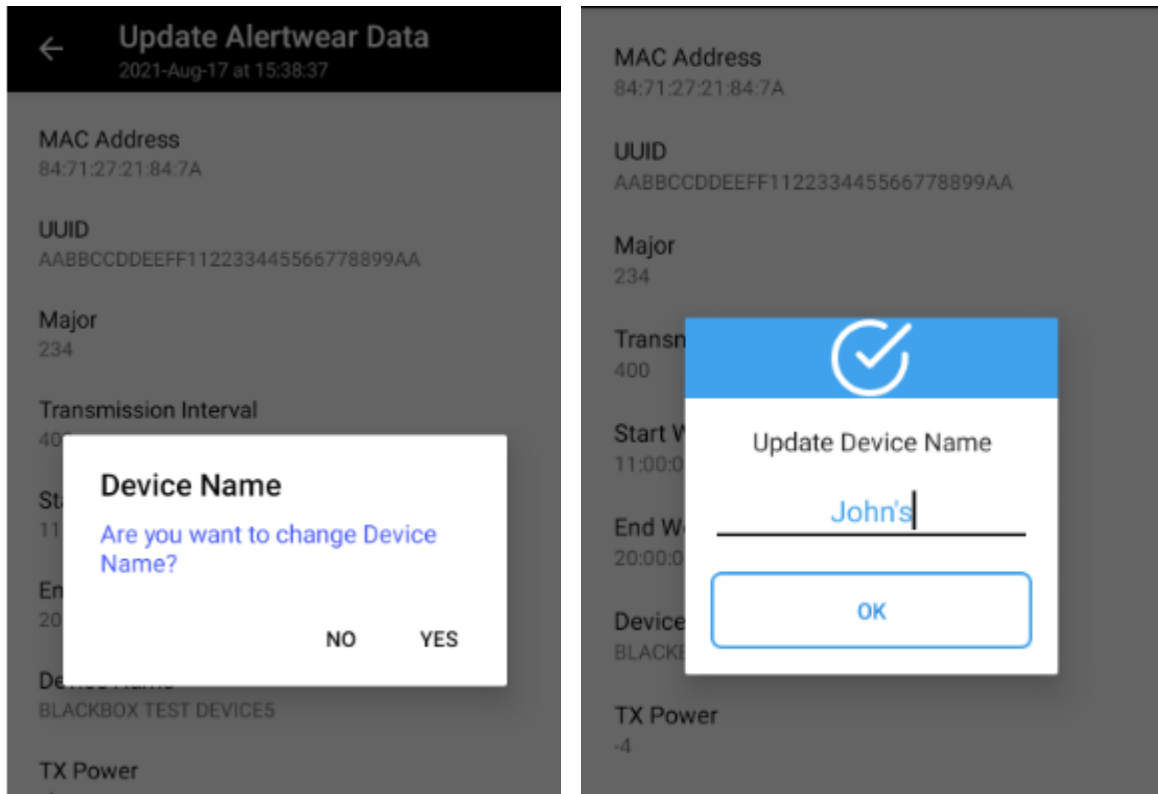

5. Once the sync is completed, Upload Alertwear Button will be changed to Red, "CLOSE" Button, by which user can either redirect to Scan Page again for updating next T20 device same as before or quiet the app.

Note:

1. Bluetooth, Location must be ON during the whole process from start to end.
2. Internet connection must be Good and uninterrupted.

